

Junction Box ECO CB

Junction box ECO CB is suitable to connect 1 or 2 self-regulating heating cables to a mains power supply. It can be used for indoor as well as protected outdoor applications in non-hazardous areas.

Features

- Wall-mounted
- Non-flammable
- Silicone- and halogene-free
- Quick and easy installation

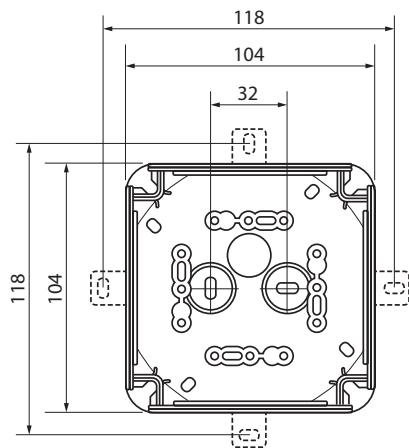

Wiring Diagram

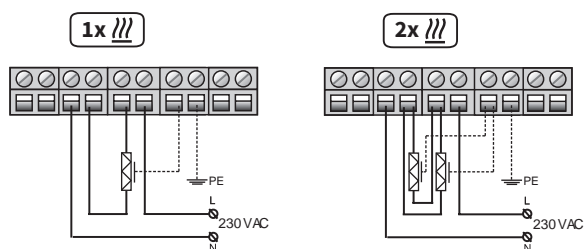

Technical Data

Degree of protection	IP66
Ambient temperature range	-25 ... +40 °C
Rated current	32 A
Rated voltage	230 VAC
Dimensions	104×104×70 mm
Weight	0.158 kg
Material	polypropylene
Color	gray

Terminal Block	
Rated connecting capacity	1.5–6 mm ² , Cu
Tightening torque	0.7 Nm

Rated connecting capacity mm ² and types of conductors	Conductors to be connected per pole
6 sol/f*	1–2
4 sol/f	1–4
2.5 sol/f	1–6
1.5 sol/f	1–8

* sol – solid conductor;
f – flexible conductor with a finer wire diameter.

Approvals



Marking

Example: ECO CBX

① ②

1. Connection box type
2. X – box model (blank, 1 and 2)

Types

Type	Order code	Connection kit	Cable glands	
			Size	Number
ECO CB	1110001001	-	M25x1,5	1
ECO CB1	1110001002	ECO SCK-S	M25x1,5	1
ECO CB2	1110001003	ECO SCK-D	M25x1,5	1